

The Button-fix concept is simple: the Fixings are attached to the back of a panel and the Locator Buttons are attached to the wall. Bring the panels together and slide until the Locator Buttons click into place.

The 3 Components

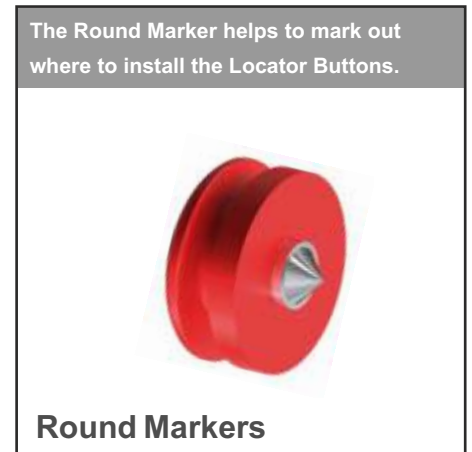
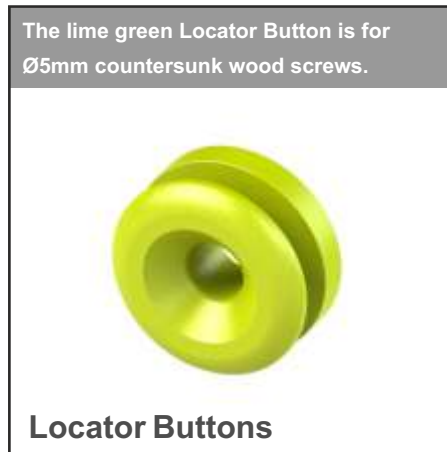

Before You Start

The Bonded Fixings should be no closer than 35mm from the edge of the panel and no further than 600mm apart from each other. You also need to allow a 15mm gap above the panel being fitted to allow the panel to be clicked into place.

Surface Mounting The Bonded Fixing

Surface mount a Bonded Fixing by using either Bostik Tensol 12 adhesive or the Button Fix Adhesive pads (sold separately). Clean the Fixing first with isopropyl alcohol.

It is imperative that all the Bonded Fixings on a panel are aligned with each other. Use a square to check alignment.

In this example, the panel is clipped into place vertically so 15mm clearance is required above the removable panel.

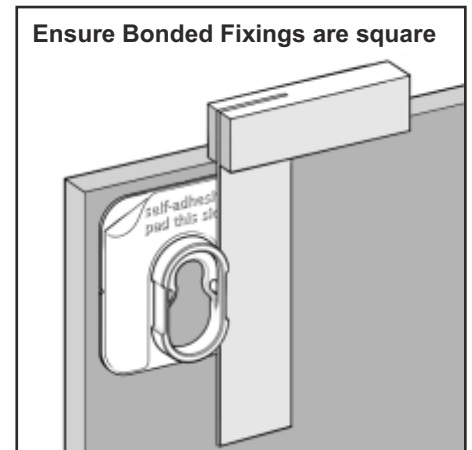

Rebated Mounting Of The Bonded Fixing

Rebating a panel can give the fixings more strength. Machine a 7mm rebate in the panel.

It is imperative that all the Bonded Fixings on a panel are aligned with each other. Use a square to check alignment.

In this example, the panel is clipped into place vertically so 15mm clearance is required above the removable panel.

The rebated Bonded Fixing will give a 2mm gap between the panel and the wall.

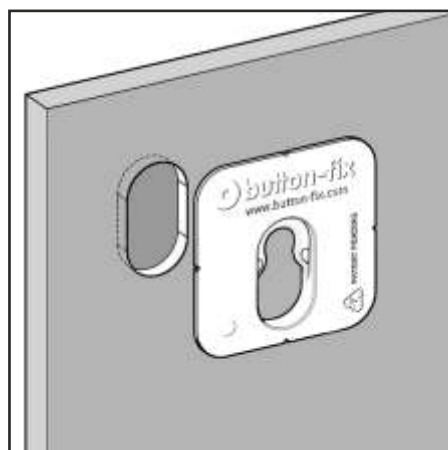

Marking The Pilot Holes

The Round Markers help to mark out where to install the Locator Buttons.

Once you have attached the Bonded Fixings to the panel put a Round Marker into each one.

Position the panel against the wall, push firmly and the Round Markers will leave indents on the surface, which can be used as guides for drilling pilot holes for the Locator Buttons.

Remove the Round Markers from each Bonded Fixing and retain for your next installation.



Locator Buttons

Drill the pilot holes in the wall and use wall plugs if appropriate.

Attach the locator buttons with 5mm diameter countersunk wood screws.

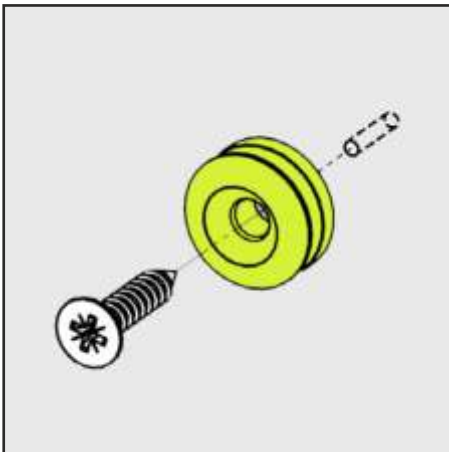

Attaching The Panel

Line up the Bonded Fixing and Locator Button so the Locator Button goes into the larger diameter part of the Bonded Fixing.

Pull the panel down by 15mm and the Locator Buttons will click into place. The panel is now locked into place.

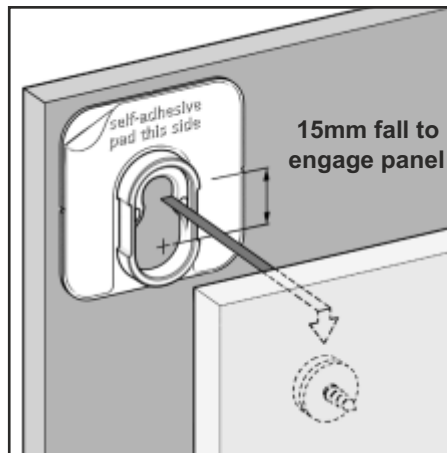

Removing The Panel

If you want to make it easier to remove the panel spray each fixing with a PTFE or Silicone based lubricant.

If the strength of the click is still too great you can reduce this further by snapping off the ears with pliers of some of the fixings.

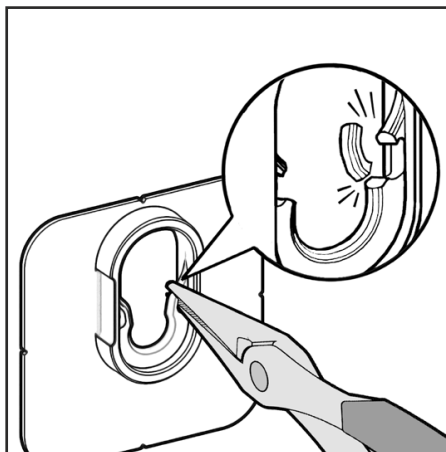

Warnings

Serious damage to property and severe bodily injury can result from improper use, application or installation of the Button-fix Fixings. These fixings are designed for internal use. If you are unsure, don't do it.